

Assembled dimensions (approx)

Aero is a smart and extremely versatile modular display system that is very easy to transport and assemble, making it ideal for all types of display application.

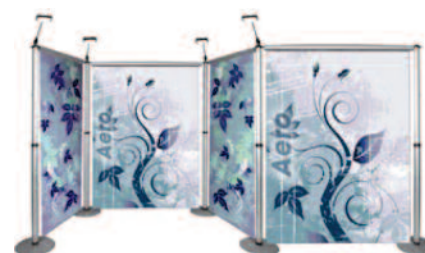

Banners can be positioned in multiple angles



The display can be expanded by linking kits together

features & benefits

- 3 single sided pull-down roller banners mounted onto telescopic support posts and bases (2 banners 1000mm wide, 1 banner 1500mm wide)
- Choice of 3 fixed visible graphic heights: 1010mm, 1510mm and 2010mm
- Lightweight anodised aluminium components
- Supplied complete with two mounting points for spot or floodlighting*
- Banners can be positioned to create a flat back-wall or can be angled to fit a variety of display spaces
- Aero's modular design makes it easy to expand the display by linking additional kits together
- Suitable for indoor use only
- Supplied with carry bags

*Suitable for PS750 or PS1000 lighting

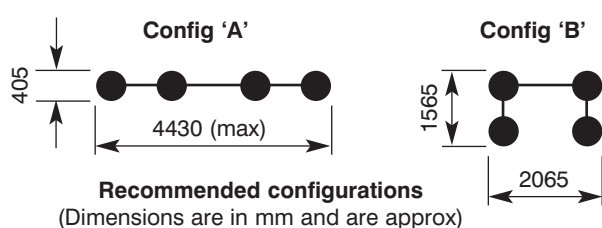

hardware specifications

Assembled dimensions (mm):
Configuration 'A'
 2120 h (max) x 4430 w x 405 d approx
Configuration 'B'
 2120 h (max) x 2065 w x 1565 d approx
Weight:
 22kg approx (including carry bags)

graphic specifications

Visible graphic dimensions (mm):
 1056 h x 990 w approx (short)
 1460 h x 990 w approx (medium)
 2025 h x 990 w approx (tall)
 1056 h x 1490 w approx (short)
 1460 h x 1490 w approx (medium)
 2025 h x 1490 w approx (tall)
Note:
 Add 265mm to **top** of graphic to allow for the roller mechanism
 Add 110mm to **base** of graphic to allow for a folded hem, finished size 55mm
Recommended graphic substrate:
 225 to 300 micron thick PVC banner vinyl

additional info

Included in kit:
 2 x 1000mm roller banners
 1 x 1500mm roller banner
 4 x telescopic posts
 4 x circular bases
 12 x cassette / rail hangers
 6 x Carry bags
Availability:
 Anodised aluminium posts and roller banners inc dark grey mouldings and powdercoated grey steel bases
Recommended accessories:
 PS1000 or PS750 lighting
Roller banners:
 Require tensioning before use (see over)

Assembly Instructions

Assembly instructions



2 x 1000mm roller banners, 1 x 1500mm roller banner, 4 x telescopic posts, 4 x circular bases, 12 x cassette / rail hangers
6 x Carry bags and 3 x allen keys



1 Unscrew wing nut located on the base of each telescopic post.



2 Attach the telescopic post to the circular base using the wing nut. Repeat step for remaining posts.



3 Slide cassette / rail hangers into the telescopic posts. Position to suit your display shape and size.

NB If displaying graphics at 90° angles, an additional cassette / rail hanger should be fitted to the base of the telescopic pole **before** the circular base is attached.



4 Extend telescopic poles to the desired height, push in the release button extend pole until button comes through the pole side.



5 Hang the roller banner on to the telescopic post. Attach the hook on the end of the banner to the cassette / rail hanger on the telescopic pole and tighten thumbscrew. Repeat step for other end of roller banner.

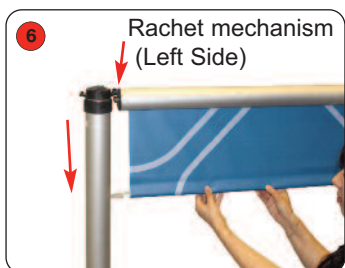

6 Pull down each roller banner.

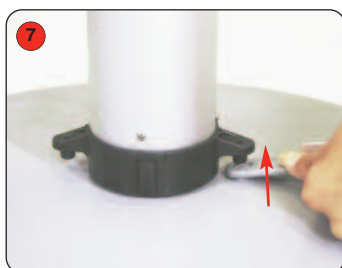

7 Attach the bottom rail to the rail rail hanger located at the bottom of the telescopic pole. Repeat step for other end of rail.



8 Slide optional lights onto the fitting attached to top of telescopic pole. **NB Lights can be only be fitted to two telescopic poles in the kit.**

Graphic attachment instructions

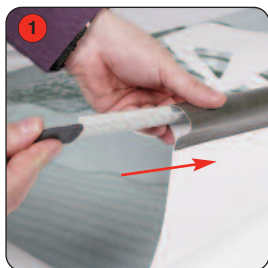

1 Slide the bottom rail into the folded hem of the banner graphic.



2 Remove the backing paper from the adhesive strip on the roller banner leader.



3 Attach the graphic to the adhesive strip. Remove the locking pin from the end of the roller banner. **NB: Make sure the ratchet mechanism is on the left and graphic is face up.**



4 Tension the roller banner using the ratchet mechanism turn clockwise to tension. Recommended number of turns: 24