

# Impact Hop-up



3 x 2 Hop-up

*Tension fabric systems are the next generation in large format graphic displays. The Evolution Hop-up is portable and easy to set-up, offering maximum impact with minimal fuss!*

## features & benefits

- Suitable for indoor use
- Available in 3 x 2, 3 x 3 x 4 and 3 x 5 straight formats
- Fabric graphic remains attached to the expanding Hop-up frame
- Quality anodised frame
- Very fast assembly
- Optional stabilising feet are available
- Optional lighting accessories PS250, PS750, and PS1000

## Frame dimensions (NB see templates for graphic details)

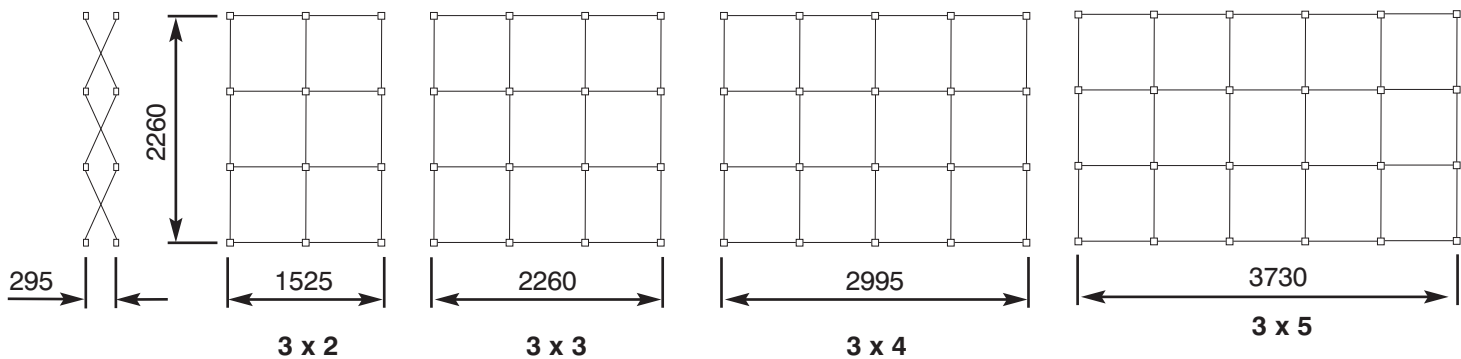

All dimensions are in mm and are approximate

### hardware specifications

Overall assembled dimensions (mm):

#### 3 x 2 Straight Hop-up

2260 (h) x 1525 (w) x 295 (d) approx  
Weight: 5.75kg approx

#### 3 x 3 Straight Hop-up

2260 (h) x 2260 (w) x 295 (d) approx  
Weight: 7.75kg approx

#### 3 x 4 Straight Hop-up

2260 (h) x 2995 (w) x 295 (d) approx  
Weight: 10.25kg approx

#### 3 x 5 Straight Hop-up

2260 (h) x 3730 (w) x 295 (d) approx  
Weight: 12.75kg approx

### graphic specifications

Recommended substrate:

Textile fabric with a high polyester content with significant elastane element in the weave to ensure stretch.

Recommended print process:

Dye-sublimation printing

Visible size and graphic dimensions:

Refer to graphic templates:

**Hop\_up\_3x2\_template\_rev1**

**Hop\_up\_3x3\_template\_rev1**

**Hop\_up\_3x4\_template\_rev1**

### additional information

Recommended accessories:

**HUB-001** Wheeled carry bag suitable for carrying one 3 x 4 Hop-up including graphics.

**ES507**

Stabilising feet (supplied in pairs)

**AG721** 50mm wide x 25m roll Loop fastener (non adhesive backed)

# Assembly Instructions



1 Hold the frame vertically and begin to expand outwards.



2 Continue to expand the frame until the graphic image appears.



3 Push the frame tubes together to fully extend the system.

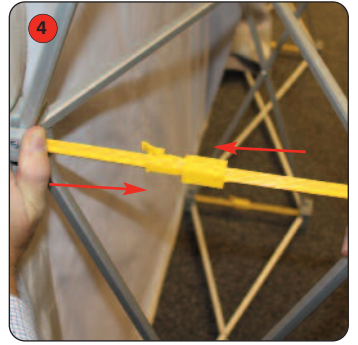

4 Push fit together each pair of locking arms. Repeat for all the remaining arms.

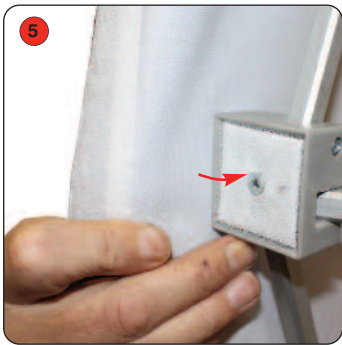

5 Wrap both vertical graphic ends tightly around the frame and fasten using hook & loop fastener.

**NB The Hop-up frame may also be assembled flat on the floor if space allows and then stood upright.**